

EASY PANEL SYSTEM

Installation Instructions

Installation is simple & fast using Monarch Z Clips

Option for Horizontal Reveals & Edge Trim to be punched with slotted holes for adjusting into place after mounting.

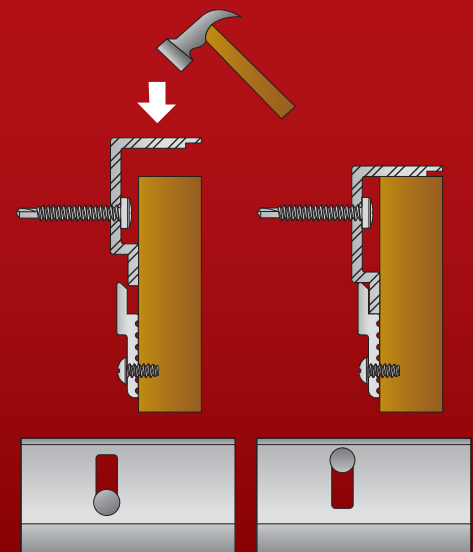

Variety of options for the appearance of the "reveal" between the panel

EASY PANEL SYSTEM

Installation Instructions



DISCLAIMER



These instructions are based on feedback from customers and our own test installations. Monarch does not give explicit structural recommendations, offers no warranty and suggests you consult with a structural engineer for your specific installation conditions.

Important Note on Relative Humidity and Panel Expansion / Contraction:

Panels expand and contract based upon changes between the humidity of the panel material and the surrounding environment. The installation needs to be made after the building HVAC systems are operational and balanced. Wide changes in the room humidity after the installation can result in panel movement that distorts the appearance or damages the installed system.

Install the bottom perimeter trim. It is critically important that you install the perimeter pieces level and plumb, as these pieces will be the basis for the remainder of the installation. The perimeter should be installed in long continuous lengths, being sure to secure the perimeter at the wall studs. We recommend #8 x 1.75" Pan Head Sheet Metal screws for installing to metal studs.



1. Installed the bottom edge trim and vertical edge trim to form the bottom and side perimeter of the panel installation.

NOTE: These profiles must be shimmed plumb and flush before moving to the next step!

Next, install the side perimeters, whether you are using corners or edge trim. You will have to cope these pieces at the intersection of the bottom edge trim and the side perimeter trim to allow for a continuous reveal. This is accomplished by notching a space in bottom edge trim and in the vertical edge trim.

To cope the piece, you will make two cuts to notch the bottom edge trim. The first cut will be a partial cut approximately 1.875" from the end as illustrated in image 2. The second cut will be just above the bottom edge, joining to the first cut to create a notch as illustrated in image 3.



2. Make a cut along the bottom edge trim that is the length of the vertical trim to which it is marrying

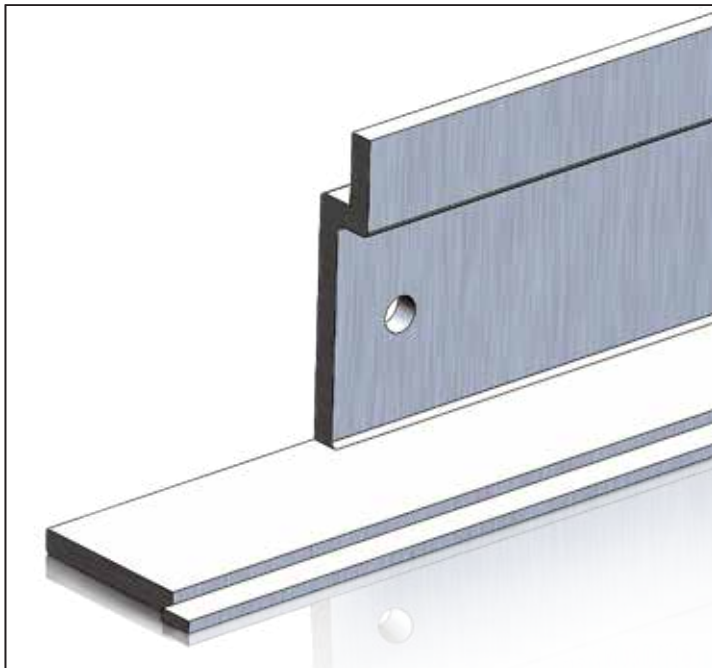

3. Make a vertical cut on the bottom edge trim to complete the notch where the vertical trim will intersect

The second cut will be a cut from, the top of the bottom edge trim to complete the notch.



4. Join the bottom edge trim to the vertical trim at the notch

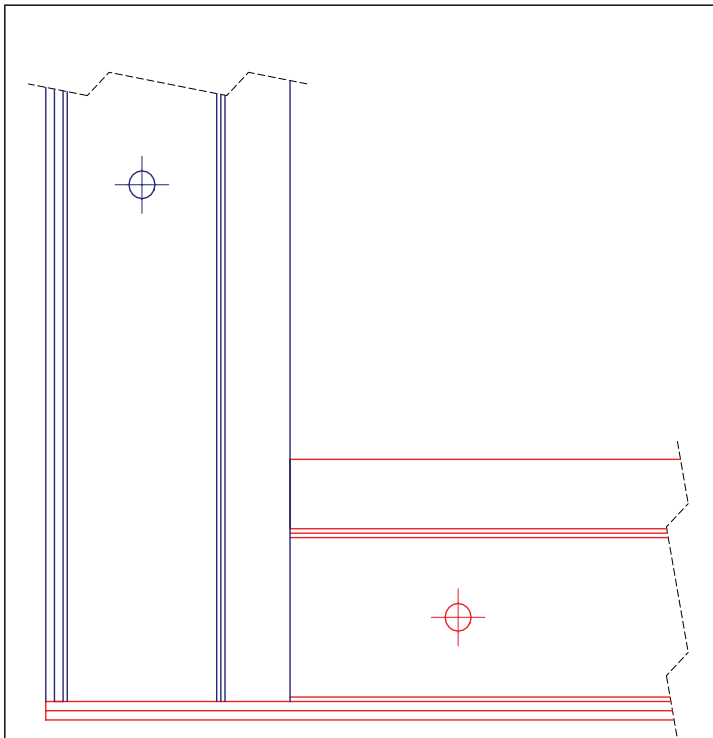

5. Plan View of Drawing Notched Piece



6. Drawing of The Two Pieces Coped Together

With the bottom and side perimeter installed, you should now design a layout for your panels so that the panels on the left and right ends are an equal width and the panels on the top and bottom are an equal height. To prepare the panels for installation, you will cut the panels to size and cut a .090" x .375" kerf where necessary to accept the spline for the vertical reveal.



7. Drawing of splined panel

You then will attach Monarch MF375-2" clips facing down on the bottom of the panel and facing up on the top of the panel. Generally, we recommend the spacing to be no more than 12-15" on center and no less than two clips in each row. The Monarch Clips will be installed so that the edges are flush with the panel edges. For the appropriate hardware / screws to attach the Monarch Clips to each panel, Monarch recommends a #8 x 3/4" Pan Head Coarse Thread Screws for 3/4" MDF panels and #8 x 7/16" Type F Pan Head Screws for 3/8" phenolic panels. Monarch recommends using pre-drilled holes and a drill stop when working with phenolic panels as the screw must be at least 1/16" from penetrating the panel.



8. Install MF375-2" Clips facing down on the bottom and facing up on the top



9. The MF375-2" Clips should face up on the top of the back-side of the panel and be flush with the top

Install the panels one row at a time working your way from the lower left hand panel across. The Monarch Clip on the bottom of the back side of the panel fits over the bottom edge trim as you work across. The vertical reveals will spline into the side of the panel and should be cut to the height of the panel.



10. First installed panel in the lower left hand side

The horizontal reveal engages with the Monarch Clips installed on the back of the panel in the same manner. You will need to cope the horizontal reveal to the Edge Trim with the same process described in Step 1.



11. Engage the horizontal reveal with the Monarch Z Clips and screw into place

Each additional row will install in the same manner as the bottom row. The Monarch MF375-2" Z Clips are installed facing down on the bottom of the panel and engage with the horizontal reveal and the clips on the top of the panel engage with the reveal on top (See illustration 12.) Continue to install clips in this manner until you reach the top row.

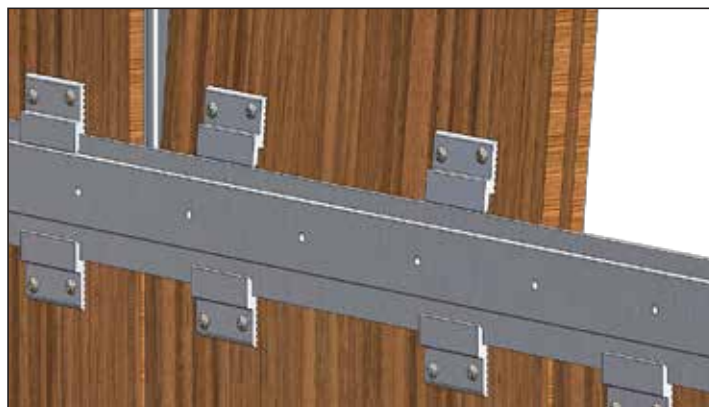

12. Install top panels by hooking the Monarch MF375-2" clip at the bottom of the panel

If you run into an issue fitting the last panel in the second row from the top, you can remove the back of the kerf in the panel to install it. The panel will still be securely fastened on Monarch Z Clips.



12. Remove the back half of the kerf on the final panel to avoid interference with the vertical reveal

Alternative Zero Lift Off Installation with 3M Dual Lock™

An alternative to have a zero lift off, removable installation is to incorporate the use of 3M Dual Lock™. A “zero lift off” means that the panel and the trim do not need to be raised above their final height to engage the system, allowing the wall panels to be installed flush to the ceiling. The system is entirely removable, where you can remove the panels for access panel needs or repair work. The panels are installed securely by being mechanically supported in shear by a Monarch Clip from the bottom and being held in place in a tensile direction by the 3M Dual Lock™.

To use the Monarch system with 3M Dual Lock™ you will need to order 1" x 2" pieces and .75" x 2" pieces from Monarch Metal. To prepare the panel for installation, you will mount the Monarch MF375-2" Clips facing down along the bottom of the rear side of the panel to be mounted. These will be installed such that the bottom edge is flush with the panel. On the top edge of the back of the panel, (2) .75" x 2" strips of 3M Dual Lock will be installed horizontally 1" in from each side of the panel and flush with the top of the panel. If you panel is wider than 2 ½ feet, you may want to consider additional attachment points in the center.



17. Rear side of a panel with 3M Dual Lock strips installed on top and MF375-2" Clips installed on bottom.



18. 3M Dual Lock being installed in the recess of the EPS-ET075-N

For phenolic panels, the surface should be cleaned with a 50/50 isopropyl alcohol solution and primed with the appropriate 3M primer.

Next tilt the panel installing the Monarch Clips on the bottom of the rear side of the panel first and then applying pressure directly over the attachment point of the 3M Dual Lock. You will physically feel the Dual Lock engage and it requires a strong pressure to engage correctly. You may need to use a rubber hammer or a roller to engage the Dual Lock.

Next tilt the panel installing the Monarch Clips on the bottom of the rear side of the panel first and then applying pressure directly over the attachment point of the 3M Dual Lock. You will physically feel the Dual Lock engage and it requires a strong pressure to engage correctly. You may need to use a rubber hammer or a roller to engage the Dual Lock.

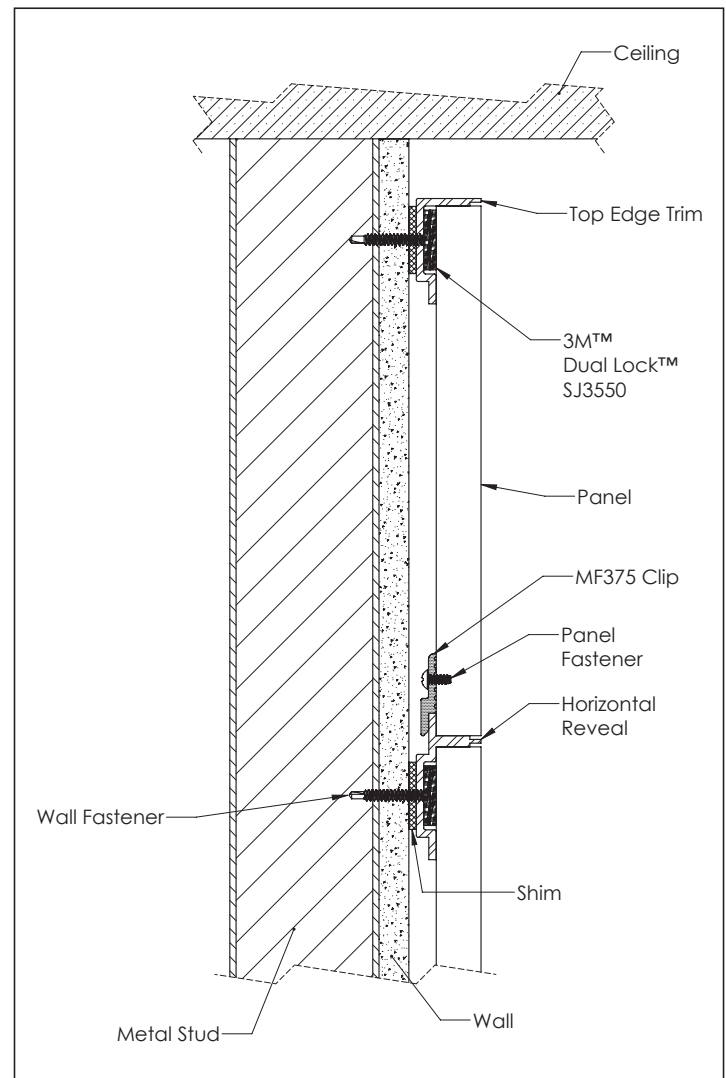

19. Install top panels by hooking the Monarch MF375-2" clip at the bottom of the panel



20. Apply pressure directly over the 3M Dual Lock. You should feel a snap when it engages.

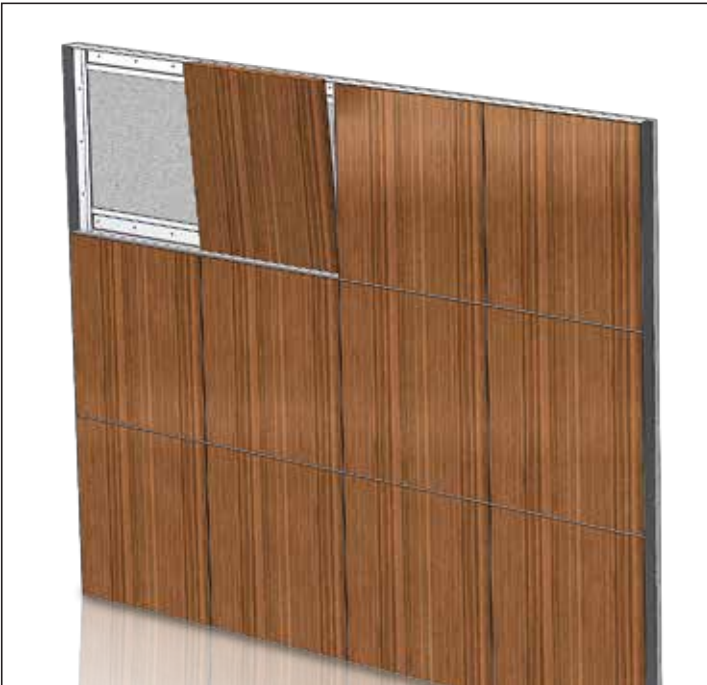

21. Continue installing top panels by hooking the bottom and utilizing 3M Dual Lock at the top

If installed correctly, the panel will be very difficult to remove with bare hands. Removing the panel will be best accomplished using a tool to begin to separate the 3M Dual Lock and give a access point to separate the Dual Lock.

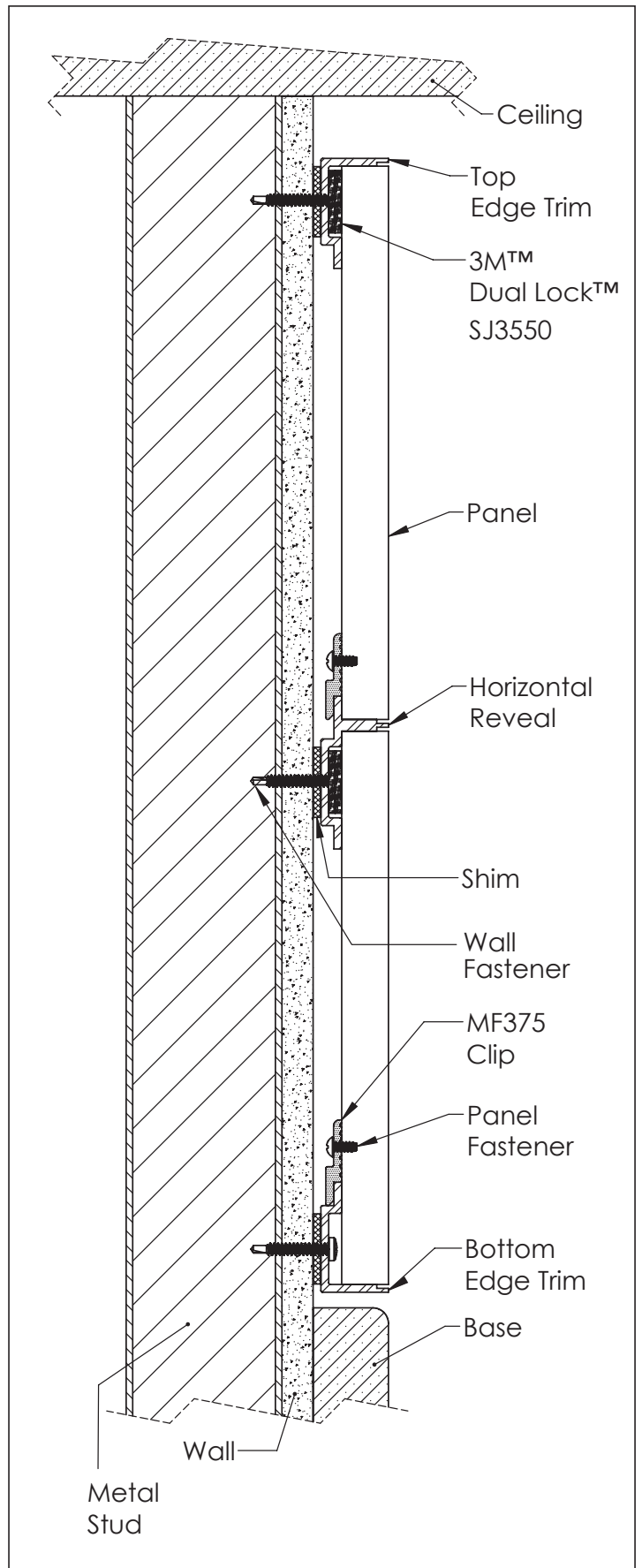

22. Sectional view of the wall panels installed with 3M Dual Lock