

## 6063-T6

## 120" Lengths

Finish:  
Black Powdercoat

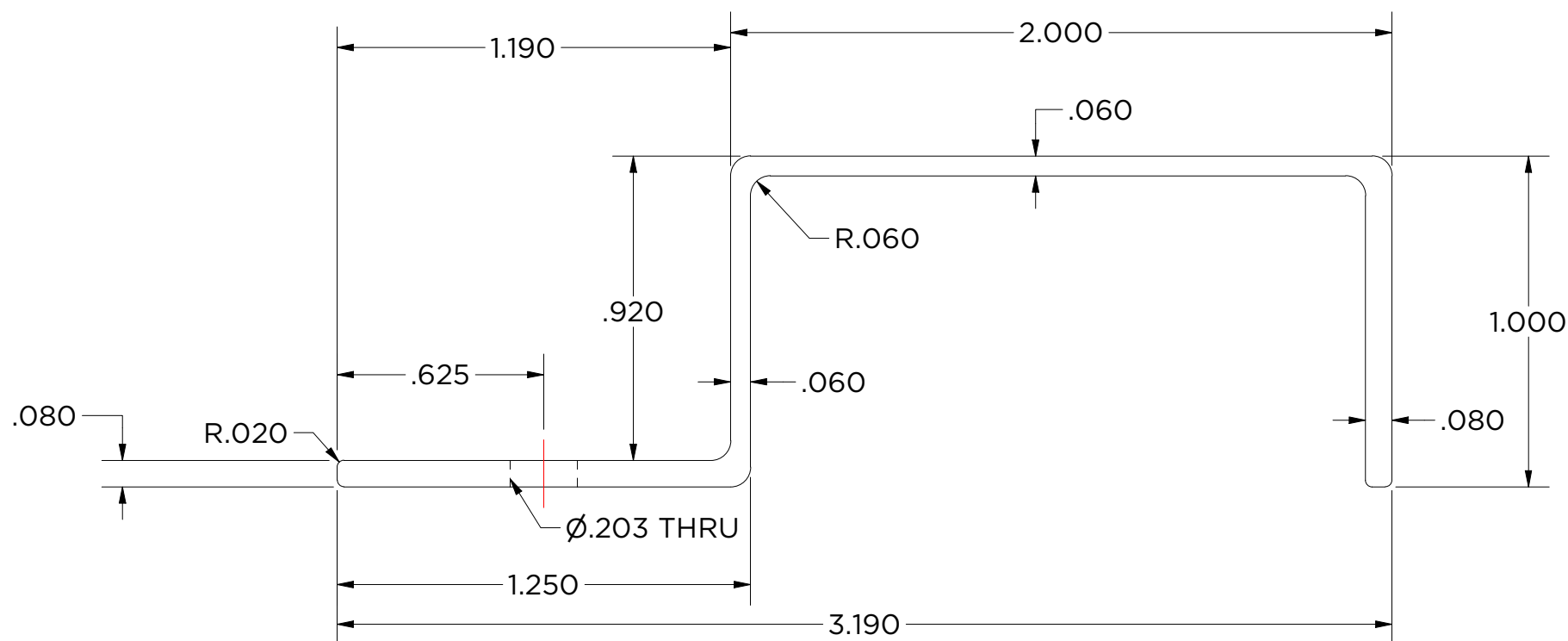

<b>Created By:</b> Aaron Hawkins	<b>Approved By:</b>	<b>Sheet Size</b> A	<b>Sheet No.</b> 1/3
<b>Creation Date:</b> 2/3/2022	<b>Approval Date:</b> 3/8/2022	<b>Scale</b> 2 : 1	<b>Rev</b> 2

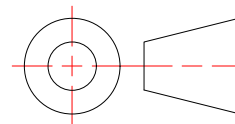

## MJCHAN

Lightweight J Channel

Aluminum 6063  
Finish: Black Powdercoat



**MONARCH**  
METAL INC.

**PROPRIETARY AND CONFIDENTIAL**

THE INFORMATION CONTAINED IN THIS DRAWING IS THE SOLE PROPERTY OF MONARCH METAL FABRICATION. ANY REPRODUCTION IN PART OR AS A WHOLE WITHOUT THE WRITTEN PERMISSION OF MONARCH METAL INC. IS PROHIBITED.

**New York**  
1700 Ocean Ave Suite 2  
Ronkonkoma NY 11779  
Phone: (631) 750-3000

**Nevada**  
1080 Linda Way, Unit 10  
Sparks, NV 89431  
Phone: (775) 415-0100

**Texas**  
1330 Post & Paddock St.,  
Suite 800  
Grand Prairie, TX 75050  
(945) 202-2700

monarchmetal.com

## Monarch MJCHAN-M

6063-T6

120" Lengths

Finish:  
Mill

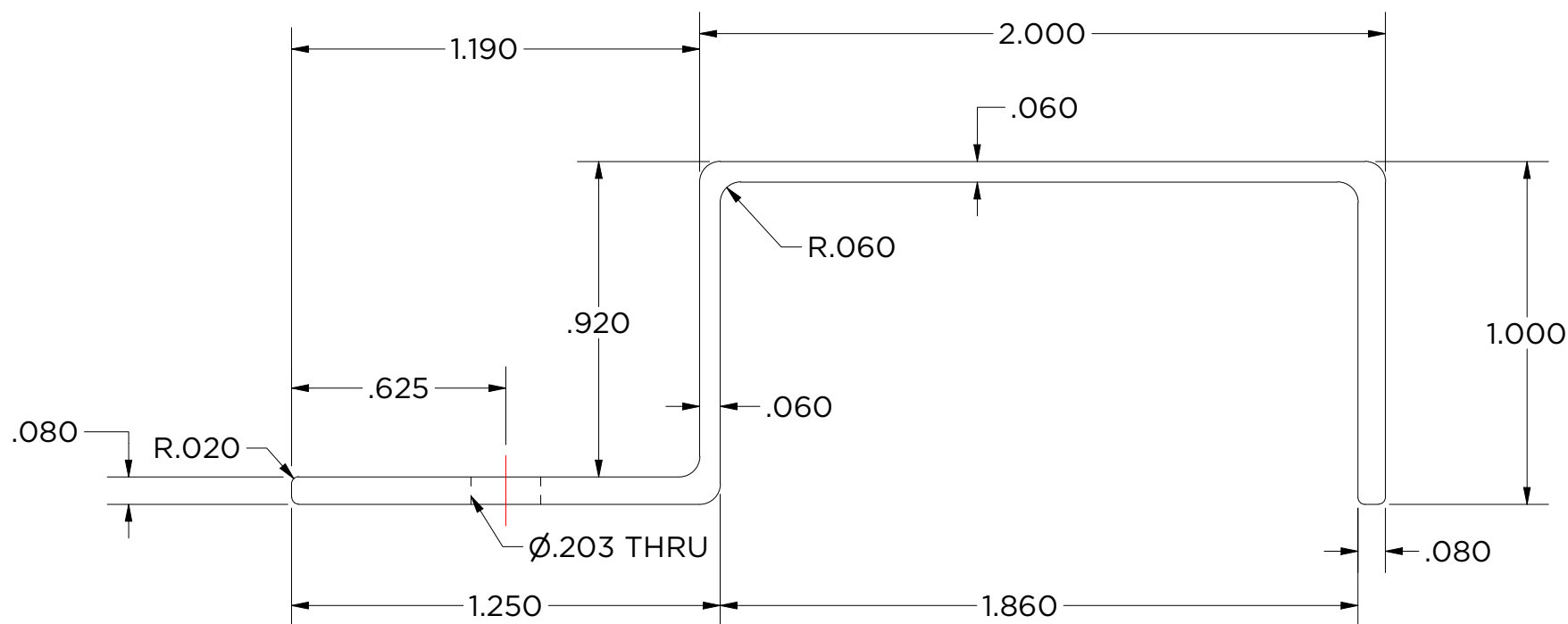

**Created By:**  
Aaron Hawkins

**Approved By:**

**Sheet Size**  
A

**Sheet No.**  
2/3

**Creation Date:**  
2/3/2022

**Approval Date:**  
3/8/2022

**Scale**  
2 : 1

**Rev**  
2

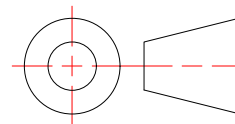

**MJCHAN**  
Lightweight J Channel

Aluminum 6063  
Finish: Mill Finish



**MONARCH**  
METAL INC.

### PROPRIETARY AND CONFIDENTIAL

THE INFORMATION CONTAINED IN THIS DRAWING IS THE SOLE PROPERTY OF MONARCH METAL FABRICATION. ANY REPRODUCTION IN PART OR AS A WHOLE WITHOUT THE WRITTEN PERMISSION OF MONARCH METAL INC. IS PROHIBITED.

**New York**  
1700 Ocean Ave Suite 2  
Ronkonkoma NY 11779  
Phone: (631) 750-3000

**Nevada**  
1080 Linda Way, Unit 10  
Sparks, NV 89431  
Phone: (775) 415-0100

**Texas**  
1330 Post & Paddock St.,  
Suite 800  
Grand Prairie, TX 75050  
(945) 202-2700

monarchmetal.com

## MJCHAN - Fabrication

### Applies to Black Powdercoat and Mill Finish Parts

.203" Thru-Holes

4" Lead-In

8" On-Center Spacing

(15) Total Holes Per Piece

### Top View

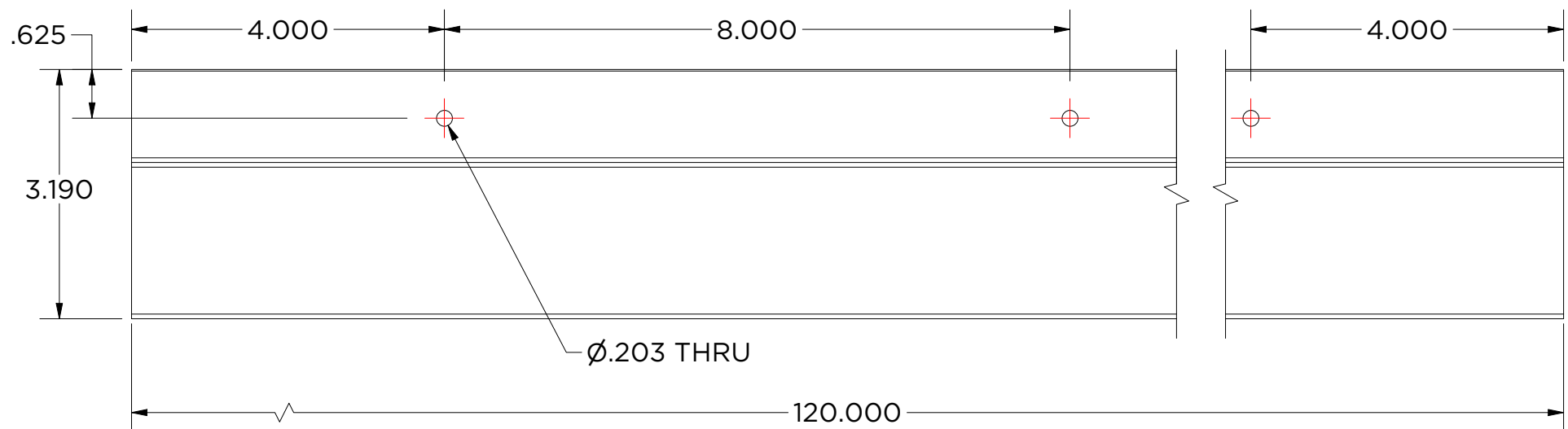

**Created By:**  
Aaron Hawkins

**Approved By:**

**Sheet Size**  
A

**Sheet No.**  
3/3

**Creation Date:**  
2/3/2022

**Approval Date:**  
3/8/2022

**Scale**  
1 / 2

**Rev**  
2

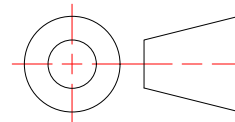

**MJCHAN**  
Lightweight J Channel

Aluminum 6063  
Finish: Black Powdercoat



**MONARCH**  
METAL INC.

#### PROPRIETARY AND CONFIDENTIAL

THE INFORMATION CONTAINED IN THIS DRAWING IS THE SOLE PROPERTY OF MONARCH METAL FABRICATION. ANY REPRODUCTION IN PART OR AS A WHOLE WITHOUT THE WRITTEN PERMISSION OF MONARCH METAL INC. IS PROHIBITED.

**New York**  
1700 Ocean Ave Suite 2  
Ronkonkoma NY 11779  
Phone: (631) 750-3000

**Nevada**  
1080 Linda Way, Unit 10  
Sparks, NV 89431  
Phone: (775) 415-0100

**Texas**  
1330 Post & Paddock St.,  
Suite 800  
Grand Prairie, TX 75050  
(945) 202-2700

monarchmetal.com